

BOTTOM VIEW OF TANK

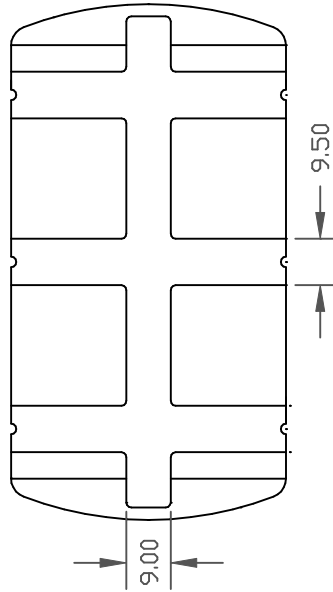

PROPRIETARY DATA

PROPERTY OF ACE ROTO-MOLD MFG., INC. INFORMATION FURNISHED HEREIN IS THE PROPERTY OF ACE ROTO-MOLD MFG., INC. AND SHALL NOT BE USED, DISCLOSED TO OTHERS, OR COPIED WITHOUT THE EXPRESSED WRITTEN CONSENT OF ACE ROTO-MOLD MFG., INC. ALL RIGHTS RESERVED.

FS1065-56W

B

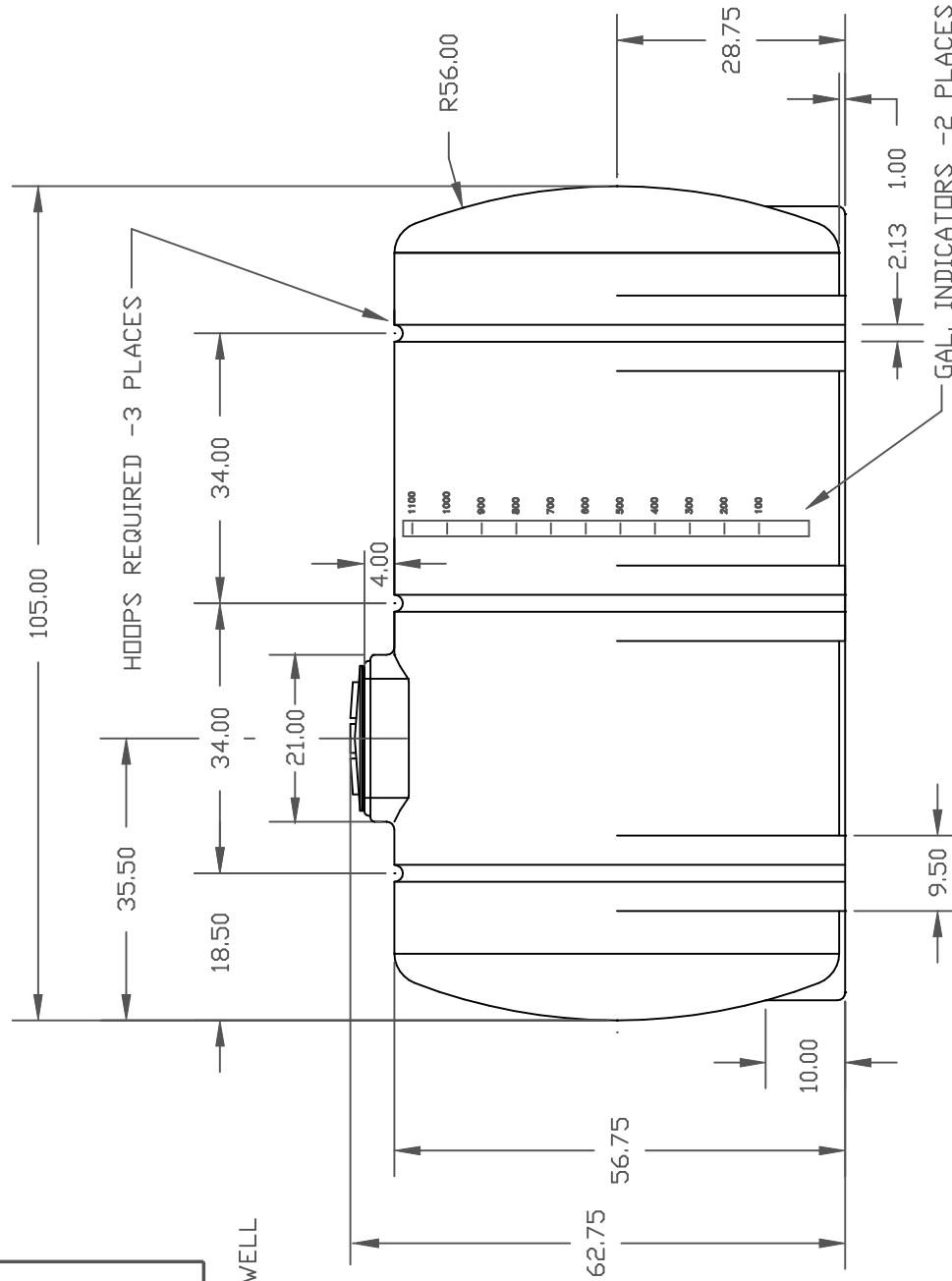

Ø4.50 CENTER OPENING

Ø16" FILLWELL

Ø56.00

FITTING CAN BE INSTALLED ON EITHER END OF TANK

(B)

| | | | |
|---|----------------------|---|-------|
| ACE ROTO-MOLD A DIVISION OF DEN HARTOG INDUSTRIES, INC. HIGHWAY 60 SOUTH, HOSPERS, IOWA | | CLIENT / DESCRIPTION ACE 1065 GAL. LEG TANK | |
| MATERIAL / SHOT WEIGHT | | SCALE N.S. | |
| M111 | M135 | U625 | P938 |
| | 340 | | |
| DRAWN / DATE REH/1/30/96 | | PART NO. FS1065-56W | |
| APPRD. / DATE REH/1/30/96 | | N.S. | |
| THIRD ANGLE PROJECTION ANSI 14.5M | | GAL. INDICATORS - 2 PLACES | |
| | | <p>NOTES:</p> <ol style="list-style-type: none"> NOM. WALL = .375 SHRINK ALLOWANCE = 2.75% RESIN IS NATURAL COLOR FDA APPROVED RESIN U.V. STABILIZED | |
| REV | DESCRIPTION | DATE | APPRD |
| B | 340 WAS 300 CCN 1457 | 9/18/07 | |
| A | WAS FS1065-58 | 3/23/06 | |
| ALL DIMENSIONS ARE IN DECIMAL INCHES TOLERANCES UNLESS OTHERWISE SPECIFIED + .5% Ø 68° F - .5% Ø 68° F | | | |